

LIQUID LINE FILTER DRIER DCHSG SERIES (WITH SIGHT GLASS)



File No. SA33181



Filter Drier with SAE connection & Sight Glass



Filter Drier with ODF connection & Sight Glass



Internal View

DIMENSIONAL DATA

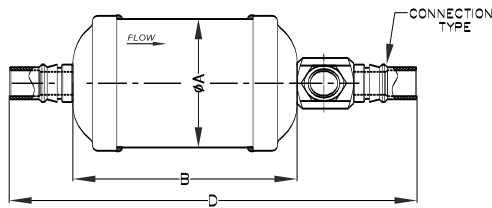

DRAWING - 1

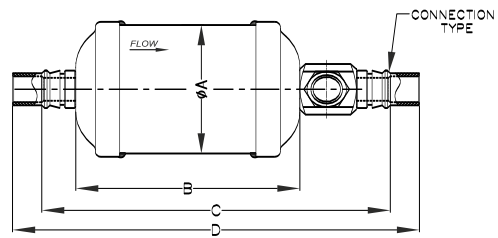

DRAWING - 2

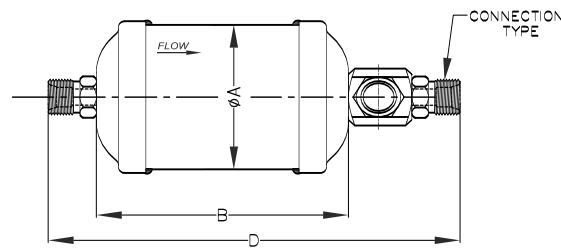

DRAWING - 3

LIQUID LINE FILTER DRIER DCHSG SERIES (WITH SIGHT GLASS)

MODELS AVAILABLE

| SR NO. | MODEL | CONNECTION TYPE (inch) | OUTER DIA ØA | | BODY LENGTH B | | STOPPER TO STOPPER LENGTH C | | OVERALL LENGTH D | | REFER DRAWING NO. | | | | |
|--------|---------------|------------------------|-----------------|-------|------------------|-------|--------------------------------|-------|---------------------|-------|----------------------|-------|-------------|------|-------------|
| | | | mm | inch | mm | inch | mm | inch | mm | inch | | | | | |
| 1 | DCHSG-052F | 1/4" SAE | Ø63.5 | Ø2.5 | 78 | 3.07 | -- | -- | 162 | 6.38 | DRAWING - 1 | | | | |
| 2 | DCHSG-052S* | 1/4" ODF | | | | | 146 | 5.75 | 166 | 6.54 | DRAWING - 2 | | | | |
| 3 | DCHSG-053F | 3/8" SAE | | | | | -- | -- | 170 | 6.69 | DRAWING - 1 | | | | |
| 4 | DCHSG-053S* | 3/8" ODF | | | | | 146 | 5.75 | 166 | 6.54 | DRAWING - 2 | | | | |
| 5 | DCHSG-082F | 1/4" SAE | | | 99 | 3.90 | 122 | 4.80 | -- | -- | 183 | 7.20 | DRAWING - 1 | | |
| 6 | DCHSG-082S* | 1/4" ODF | | | | | | | 167 | 6.57 | 187 | 7.36 | DRAWING - 2 | | |
| 7 | DCHSG-083F | 3/8" SAE | | | | | | | -- | -- | 191 | 7.52 | DRAWING - 1 | | |
| 8 | DCHSG-083S* | 3/8" ODF | | | | | | | 167 | 6.57 | 187 | 7.36 | DRAWING - 2 | | |
| 9 | DCHSG-084F | 1/2" SAE | | | | | -- | -- | 197 | 7.76 | DRAWING - 1 | | | | |
| 10 | DCHSG-084S* | 1/2" ODF | | | | | 167 | 6.57 | 193 | 7.60 | DRAWING - 2 | | | | |
| 11 | DCHSG-163F | 3/8" SAE | | | | | Ø76.2 | Ø3 | 129 | 5.07 | -- | -- | 214 | 8.43 | DRAWING - 1 |
| 12 | DCHSG-163S* | 3/8" ODF | | | | | | | | | 190 | 7.48 | 210 | 8.27 | DRAWING - 2 |
| 13 | DCHSG-164F | 1/2" SAE | | | -- | -- | | | | | 220 | 8.66 | DRAWING - 1 | | |
| 14 | DCHSG-164S* | 1/2" ODF | | | 190 | 7.48 | | | | | 216 | 8.50 | DRAWING - 2 | | |
| 15 | DCHSG-164-ORN | 1/2" O-Ring | | | -- | -- | | | | | 205 | 8.07 | DRAWING - 3 | | |
| 16 | DCHSG-165F | 5/8" SAE | | | -- | -- | | | | | 228 | 8.98 | DRAWING - 1 | | |
| 17 | DCHSG-165S* | 5/8" ODF | 190 | 7.48 | 220 | 8.66 | | | DRAWING - 2 | | | | | | |
| 18 | DCHSG-303F | 5/8" ODF | 190 | 7.48 | 190 | 7.48 | | | 190 | 7.48 | 220 | 8.66 | DRAWING - 3 | | |
| 19 | DCHSG-303F | 3/8" SAE | | | | | | | -- | -- | 282 | 11.10 | DRAWING - 1 | | |
| 20 | DCHSG-303S* | 3/8" ODF | | | | | | | 258 | 10.16 | 278 | 10.94 | DRAWING - 2 | | |
| 21 | DCHSG-304F | 1/2" SAE | | | | | | | -- | -- | 288 | 11.34 | DRAWING - 1 | | |
| 22 | DCHSG-304S* | 1/2" ODF | | | 258 | 10.16 | | | 284 | 11.18 | DRAWING - 2 | | | | |
| 23 | DCHSG-305F | 5/8" SAE | | | -- | -- | | | 296 | 11.65 | DRAWING - 1 | | | | |
| 24 | DCHSG-305S* | 5/8" ODF | | | 258 | 10.16 | | | 288 | 11.34 | DRAWING - 2 | | | | |
| 25 | DCHSG-306F | 3/4" SAE | | | -- | -- | 302 | 12.13 | DRAWING - 1 | | | | | | |
| 26 | DCHSG-306S* | 3/4" ODF | | | 258 | 10.16 | 296 | 11.65 | DRAWING - 2 | | | | | | |
| 27 | DCHSG-307S* | 7/8" ODF | | | 260 | 10.24 | 304 | 11.97 | DRAWING - 2 | | | | | | |
| 28 | DCHSG-309S* | 1-1/8" ODF | 260 | 10.24 | 314 | 12.36 | DRAWING - 2 | | | | | | | | |
| 29 | DCHSG-414F | 1/2" SAE | Ø88.9 | Ø4 | 196 | 7.80 | -- | -- | 296 | 11.65 | DRAWING - 1 | | | | |
| 30 | DCHSG-414S* | 1/2" ODF | | | | | 266 | 10.47 | 292 | 11.50 | DRAWING - 2 | | | | |
| 31 | DCHSG-415F | 5/8" SAE | | | | | -- | -- | 304 | 11.97 | DRAWING - 1 | | | | |
| 32 | DCHSG-415S* | 5/8" ODF | | | | | 266 | 10.47 | 296 | 11.65 | DRAWING - 2 | | | | |
| 33 | DCHSG-417S* | 7/8" ODF | | | 268 | 10.55 | 312 | 12.28 | DRAWING - 2 | | | | | | |
| 34 | DCHSG-419S* | 1-1/8" ODF | | | 268 | 10.55 | 322 | 12.66 | DRAWING - 2 | | | | | | |

- 1) Internal Assembly - Solid Core Type
- 2) Maximum Working Pressure - 45 bar (653 psig)
- 3) SAE, ORFS & 'O' Ring Type Connection are in Steel, Nickel Plated
- 4) ODF Type Connection is in Steel & Nickel Plated
- 5) *Mark Connection Steel Plated

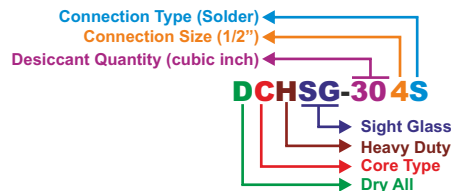

LIQUID LINE FILTER DRIER DCHSG SERIES (WITH SIGHT GLASS)

SELECTION RECCOMENDATION

| SR NO. | Description | Connections Type | Flow Capacity Ton @ 1psi ΔP (for kw multiply Ton by 3.5) | | | | Water Capacity drops of water | | | | | | | | | |
|--------|-----------------|------------------|--|------------------|--------|-------------------|-------------------------------|-------|------|-------|--------|-------|--------|-------|-------------------|-------|
| | | | R-134a | R-22 & R-410A | R-407C | R-404A & R-507 | R-134a | | R-22 | | R-407C | | R-410A | | R-404A & R-507 | |
| | | | | | | | 75°F | 125°F | 75°F | 125°F | 75°F | 125°F | 75°F | 125°F | 75°F | 125°F |
| 1 | DCHSG - 052F | 1/4" SAE | 2 | 2.28 | 2.28 | 1.42 | 201 | 186 | 186 | 136 | 156 | 126 | 131 | 101 | 206 | 196 |
| 2 | DCHSG - 052S | 1/4" ODF | | | | | | | | | | | | | | |
| 3 | DCHSG - 053F | 3/8" SAE | | | | | | | | | | | | | | |
| 4 | DCHSG - 053S | 3/8" ODF | 5.14 | 5.42 | 5.42 | 4 | | | | | | | | | | |
| 5 | DCHSG - 082F | 1/4" SAE | 2 | 2.28 | 2.28 | 1.42 | 265 | 245 | 250 | 225 | 205 | 165 | 170 | 130 | 275 | 260 |
| 6 | DCHSG - 082S | 1/4" ODF | | | | | | | | | | | | | | |
| 7 | DCHSG - 083F | 3/8" SAE | | | | | | | | | | | | | | |
| 8 | DCHSG - 083S | 3/8" ODF | 5.42 | 6 | 6 | 4 | | | | | | | | | | |
| 9 | DCHSG - 084F | 1/2" SAE | 7.42 | 8.28 | 8.28 | 5.71 | 490 | 463 | 360 | 342 | 400 | 364 | 350 | 314 | 672 | 364 |
| 10 | DCHSG - 084S | 1/2" ODF | | | | | | | | | | | | | | |
| 11 | DCHSG - 163F | 3/8" SAE | | | | | | | | | | | | | | |
| 12 | DCHSG - 163S | 3/8" ODF | 6.2 | 6.8 | 6.8 | 4.57 | | | | | | | | | | |
| 13 | DCHSG - 164F | 1/2" SAE | 8.5 | 9.4 | 9.4 | 6.2 | 396 | 366 | 271 | 336 | 306 | 246 | 256 | 196 | 406 | 286 |
| 14 | DCHSG - 164S | 1/2" ODF | | | | | | | | | | | | | | |
| 15 | DCHSG - 164-ORN | 13/16-16ORFS | | | | | | | | | | | | | | |
| 16 | DCHSG - 165F | 5/8" SAE | 12.2 | 13.4 | 13.4 | 8.57 | 877 | 812 | 822 | 752 | 687 | 552 | 567 | 432 | 907 | 857 |
| 17 | DCHSG - 165S | 5/8" ODF | | | | | | | | | | | | | | |
| 18 | DCHSG - 165R | 11/16-16 ORFS | | | | | | | | | | | | | | |
| 19 | DCHSG - 303F | 3/8" SAE | 6 | 6.57 | 6.57 | 4.28 | 1216 | 1106 | 1146 | 1016 | 951 | 746 | 786 | 586 | 1266 | 1162 |
| 20 | DCHSG - 303S | 3/8" ODF | | | | | | | | | | | | | | |
| 21 | DCHSG - 304F | 1/2" SAE | | | | | | | | | | | | | | |
| 22 | DCHSG - 304S | 1/2" ODF | 8.85 | 9.71 | 9.71 | 6.28 | | | | | | | | | | |
| 23 | DCHSG - 305F | 5/8" SAE | 12.85 | 14 | 14 | 9.42 | 877 | 812 | 822 | 752 | 687 | 552 | 567 | 432 | 907 | 857 |
| 24 | DCHSG - 305S | 5/8" ODF | | | | | | | | | | | | | | |
| 25 | DCHSG - 306F | 3/4" SAE | | | | | | | | | | | | | | |
| 26 | DCHSG - 306S | 3/4" ODF | 17.71 | 19.42 | 19.42 | 12.85 | | | | | | | | | | |
| 27 | DCHSG - 307S* | 7/8" ODF | 17.71 | 19.42 | 19.42 | 12.85 | 1216 | 1106 | 1146 | 1016 | 951 | 746 | 786 | 586 | 1266 | 1162 |
| 28 | DCHSG - 309S* | 1-1/8" ODF | | | | | | | | | | | | | | |
| 29 | DCHSG - 414F | 1/2" SAE | | | | | | | | | | | | | | |
| 30 | DCHSG - 414S | 1/2" ODF | 9.14 | 10 | 10 | 6.57 | | | | | | | | | | |
| 31 | DCHSG - 415F | 5/8" SAE | 15.14 | 16.57 | 16.57 | 10.57 | 1216 | 1106 | 1146 | 1016 | 951 | 746 | 786 | 586 | 1266 | 1162 |
| 32 | DCHSG - 415S | 5/8" ODF | | | | | | | | | | | | | | |
| 33 | DCHSG - 417S* | 7/8" ODF | | | | | | | | | | | | | | |
| 34 | DCHSG - 419* | 1-1/8" ODF | 26 | 28.57 | 28.57 | 18.57 | | | | | | | | | | |

All ratings are in accordance with ANSI/AHRI Standard 710-2009

1. Water in refrigerant at EPD for :

R-134a/R-407C/R-410A/R-404A/R-507A is 50 ppm,
R-22 is 60 ppm.

2. Flow Capacities are based on following standard rating

Flow Rate per Ton of Refrigeration at 86°F Liquid & 5.0°F Saturated Vapor for :

R-134a is 3.1 lb/min/ton,
R-407C is 3.0 lb/min/ton,
R-410A is 2.8 lb/min/ton,
R-404A is 4.1 lb/min/ton,
R-507A is 4.2 lb/min/ton,
R-22 is 3.0 lb/min/ton.